

State of Wyoming Corner Record

(In compliance with the *CORNER PERPETUATION AND FILING ACT*, Wyoming Statutes, 1997, Section 33-29-140, et. seq., and the Rules and Regulations of the Board of Registration for Professional Engineers and Professional Land Surveyors)

Reverse side of this form may be used if more space is needed.

Record of original survey and citation of source of historical information (if corner is lost or obliterated). Description of corner monumentation evidence found and/or monument and accessories established to perpetuate the location of this corner. Sketch of relative location of monument, accessories, and reference points with course and distance to adjacent corner(s) (if determined in this survey). Method and rationale for reestablishment of lost or obliterated corner.

G.L.O. Record: John B. Thomas, U.S. Deputy Surveyor, June 1871

Found: No. 5 x 24 ins. rebar with 1 1/2 ins. diam. alum. cap set by me, in a survey while employed by Steil Surveying Services, for the McConnaughey #1-23 well location in 1992. Based upon measurements to adjacent reestablished corners north, south, east and west and after a thorough search for perpetuation accessories and county road stones, I set this monument at proportionate distances and found it to be fairly harmonious with County Road 135 center line and fenced rows east and west.

Set: I remove the No. 5 rebar and 1 1/2 ins. diam. alum. cap and remonument with a No. 6 x 24 ins. rebar with 3 1/4 ins. diam. alum. cap, 8 ins. below County Road No. 135. I bury the 1 1/2 diam. alum. cap alongside as a memorial.

From my field notes dated July 1, 1992:

- A p.k nail set nw'ly in the south face of a 40 ft. power pole @ 42.18 ft.
- A p.k nail set sw'ly in a fence corner post @ 41.09 ft.
- A p.k nail set se'ly in a railroad tie fence corner post @ 44.36 ft.
- A p.k nail set ne'ly in a railroad tie fence corner post @ 40.12 ft.

Aluminum Cap Markings

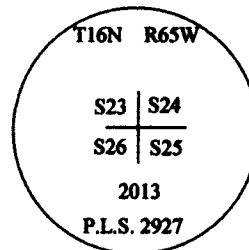

RECORDED 11/12/2013 AT 2:59 PM REC# 627444 BK# 2366 PG# 881
 DEBRA K. LATHROP, CLERK OF LARAMIE COUNTY, WY PAGE 1 OF 1

Date of Field Work: November 1, 2013

Office Reference: Kaiser Francis Silo Field

CROSS INDEX DIAGRAM

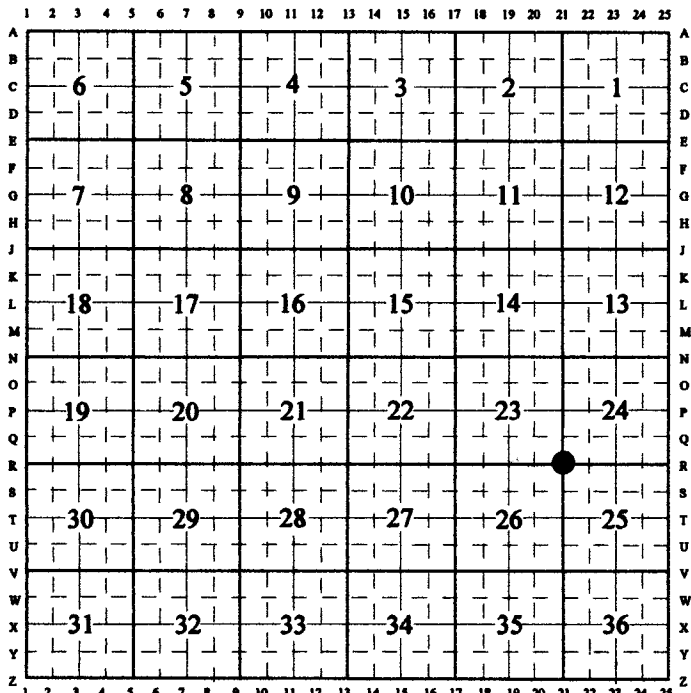

Firm/Agency, Address

Paul Reid, PLS
 1533 Pinion Drive
 Cheyenne WY 82001
 307-630-2387 (C)
 307-637-3400 (O)

This corner record was prepared by me or under my direction and supervision.

SEAL & SIGNATURE

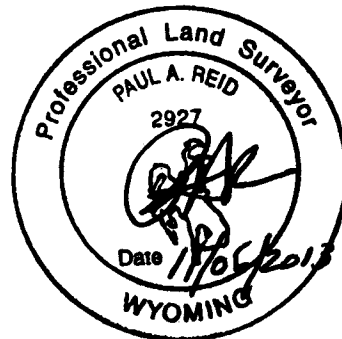

Corner Name: NW Cor Section: 25 T. 16 N., R. 65 W., 6th P.M.,
 SBRPEPLS/PLSW: MARCH 1994/97

Cross-Index No.: R-21